

The Cincinnati Crane

# WIRELESS REMOTE

Powered by Schneider Electric





# REMOTE ADVANTAGES

This powerful remote control offers the latest in smart technology while providing advanced safety features and ease of use in a wireless handheld device.



**Ergonomic  
Design**



**Increased  
Functionality**



**Reliability**



**Safety  
Control**



**User  
Accountability**



**Battery  
Advantages**



**Adaptability**







# Ergonomic Design

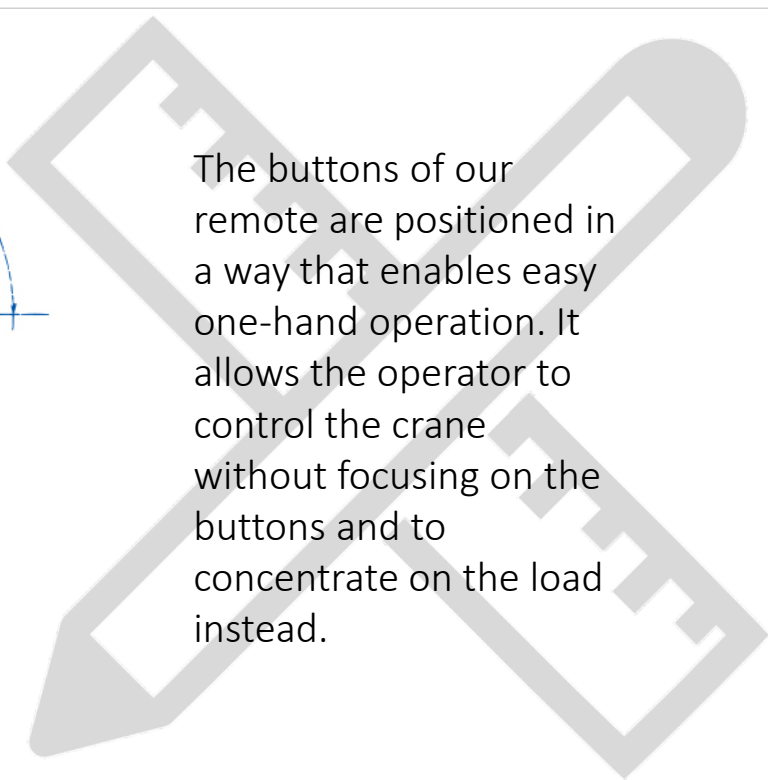

The buttons of our remote are positioned in a way that enables easy one-hand operation. It allows the operator to control the crane without focusing on the buttons and to concentrate on the load instead.

- **Intuitive one hand operation**
- **No wires to inhibit movement**
- **Reduces operator fatigue**
- **Simplify complex manoeuvres**



# Increased Functionality

Powered by cutting-edge technology, our remote offers numerous capabilities you won't be able to get with traditional remotes, giving you more critical information with more ease.

- **Multiple crane control**
- **Weight indicator on display screen**
- **Provides preventative maintenance data**
- **Able to perform dual and tandem picks**
- **Logs Safe Working Periods**
- **Access the load spectrum**
- **Pitch and catch capability**





# Reliability

Our remote uses the globally compatible 2.4GHz frequency so you can deploy the same solution worldwide and standardize your spare parts stock. It also prevents interference between many remote control stations, allowing up to 50 systems running simultaneously.

- **Unrestricted worldwide use with a global frequency**
- **Single 2.4GHz frequency for entire range**
- **100 meters operating range**
- **Automatic frequency hopping**
- **Easy System Pairing**





# Safety Controls

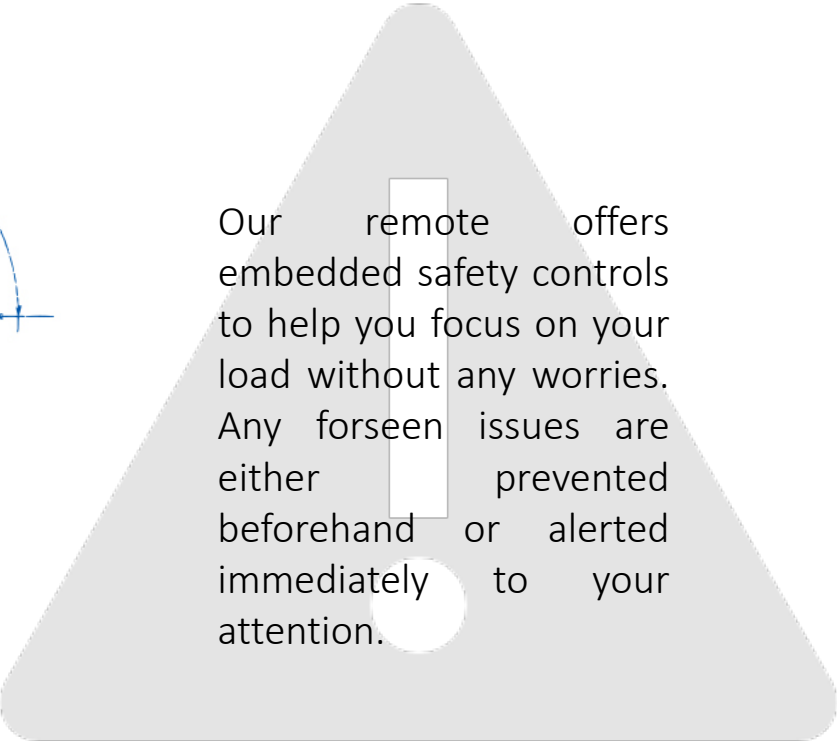

Our remote offers embedded safety controls to help you focus on your load without any worries. Any foreseen issues are either prevented beforehand or alerted immediately to your attention.

- **E-stop compliant with the highest functional safety level**
- **Detects unexpected movements**
- **Limiter protection function reduces the wiring of the installation**
- **Crane Collision Avoidance**
- **Accessible Emergency Stop**
- **Vibration Awareness Alarm**



# User Accountability

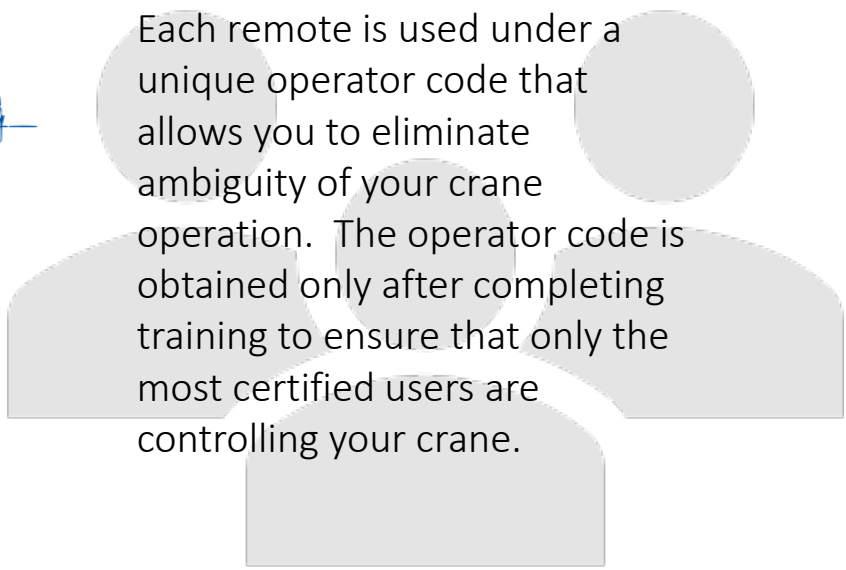

Each remote is used under a unique operator code that allows you to eliminate ambiguity of your crane operation. The operator code is obtained only after completing training to ensure that only the most certified users are controlling your crane.

- **Unique user sign-on code**
- **Isolate issues and identify cause**
- **Provides detailed usage history**





# Battery Advantages

Thanks to innovative battery technology, you gain a very high time to charge/autonomy ratio. The short charge time for the battery eliminates the need for a back-up. The estimated lifetime of our remote is around five years, double the life of a traditional battery.

- **30 hours with 15-minute recharge**
- **Up to 8 hours of autonomy with only 5 minutes of charge**
- **Built in battery- no dusty contact issue**
- **No need to manage batteries stations**
- **Less downtime, more mobility**





# Adaptability

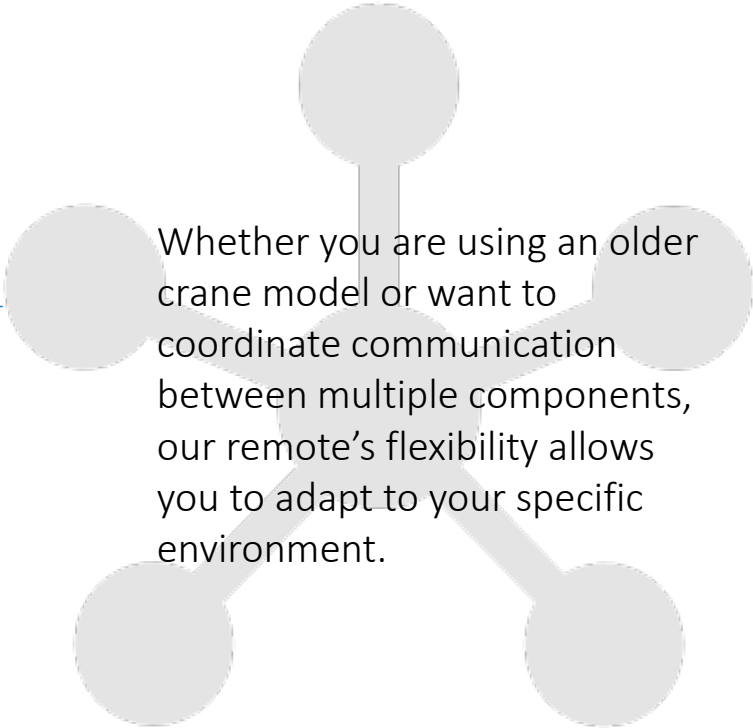

Whether you are using an older crane model or want to coordinate communication between multiple components, our remote's flexibility allows you to adapt to your specific environment.

- Analog option card
- Option of AC and DC compatibility
- Communicates with ancillary devices

# SPECIAL FUNCTIONS



# Multi-base control function

Easily configure your application

- Simultaneously control **two cranes** with the multi-base control function
  - Easily configuration of different architectures by software (tandem, master/ slave, or master/master)
- Change the operation mode quickly with a simple un-pairing procedure

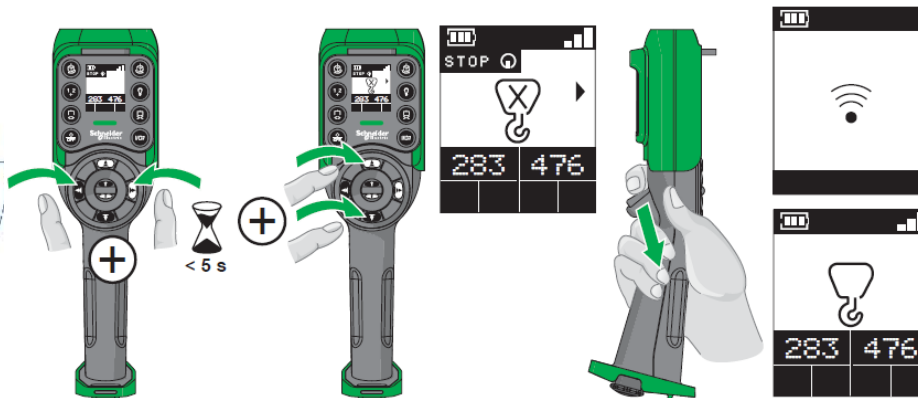

Page 11

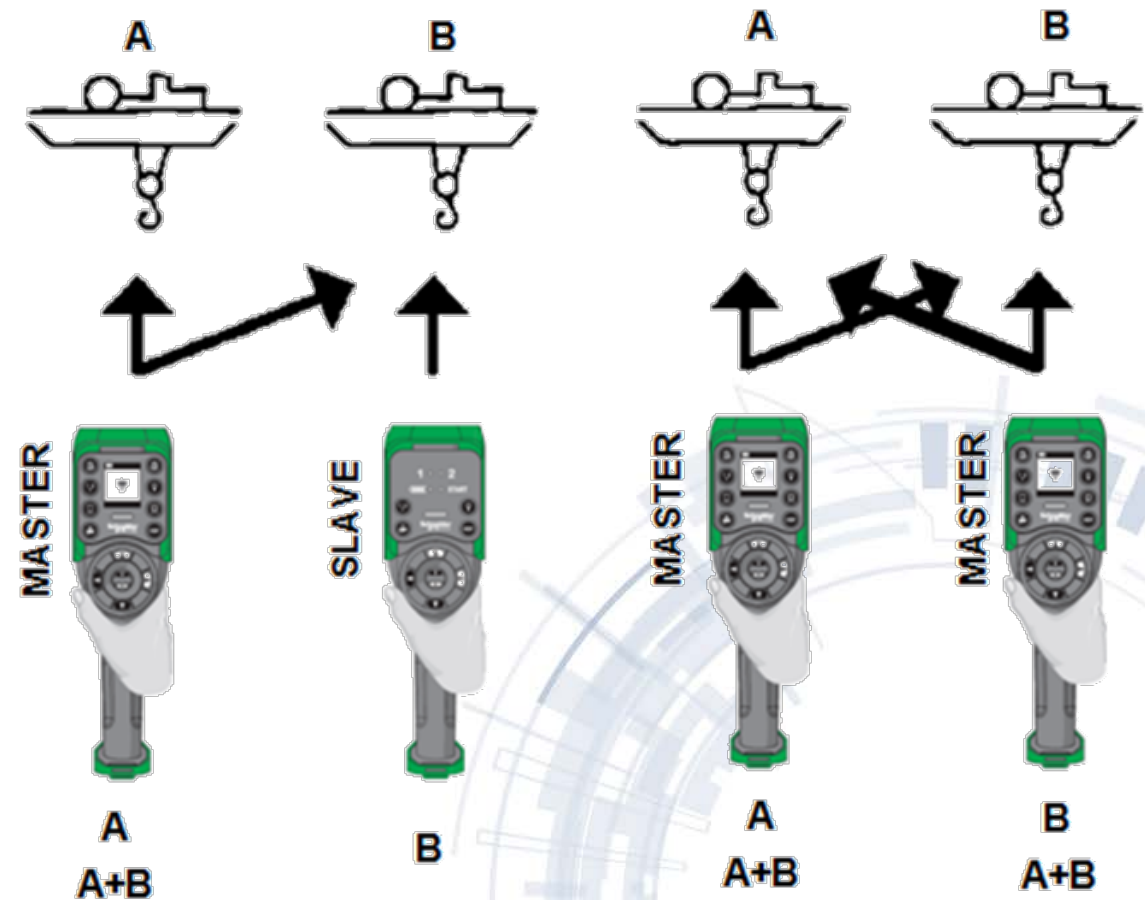



# Multi-base control function

Easily configure your application

- Possibility to add **two selector switches**, one for each base station (two trolley by crane)
- Overload and rest of warnings of each crane are displayed immediately on the remote control

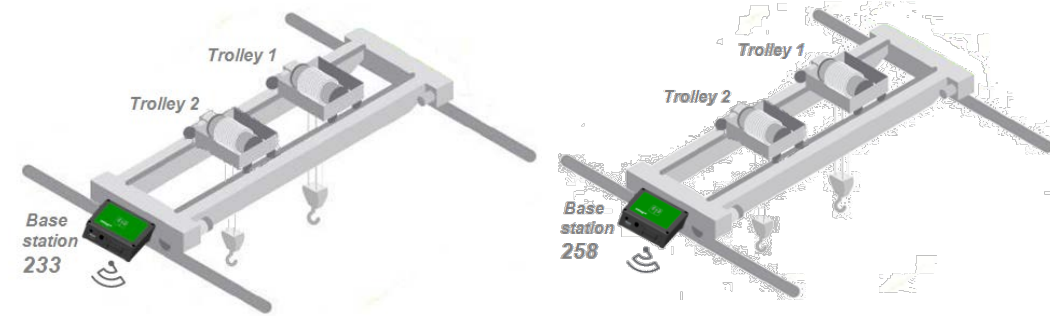

Parameters Relays Assignment Interlocking Alarm Assignment Data St

Identification Settings

Remote

☐ Single

☒ Tandem

Slave

Master

		Auxiliary selectors		Base selection
		A	B	
Enable		<input checked="" type="checkbox"/>	<input checked="" type="checkbox"/>	
Nb Button		10	12	11
Nb position		3	2	7, 7+8, 8
Change in RUN		<input checked="" type="checkbox"/>	<input checked="" type="checkbox"/>	
Base station choice	ID primary	00 80 F4 00 00 00	<input checked="" type="checkbox"/> Label 7	<input checked="" type="checkbox"/>
	ID secondary	00 80 F4 00 00 01	<input checked="" type="checkbox"/> Label 8	<input checked="" type="checkbox"/>

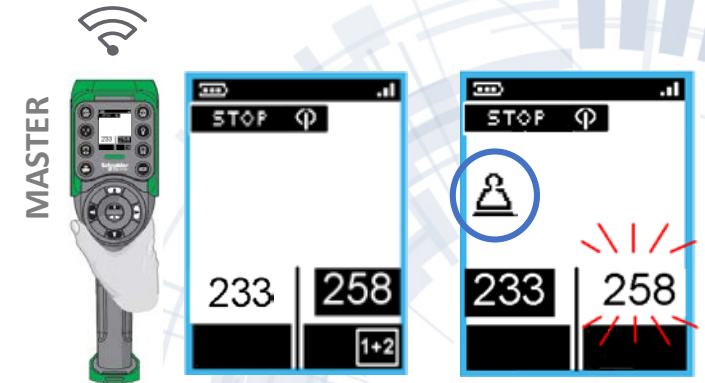

Remote control is using trolley 1 and 2 from the crane 258

Crane 258 is Overload!

# Multi-base control function

New Wireless Limit Switch Function

Crane's speed and position is sent by radio, **saving wiring cost** and reducing commissioning time:

- Overload or anti-collision feedback of one crane is immediately transferred to the second one and displayed on the remote device

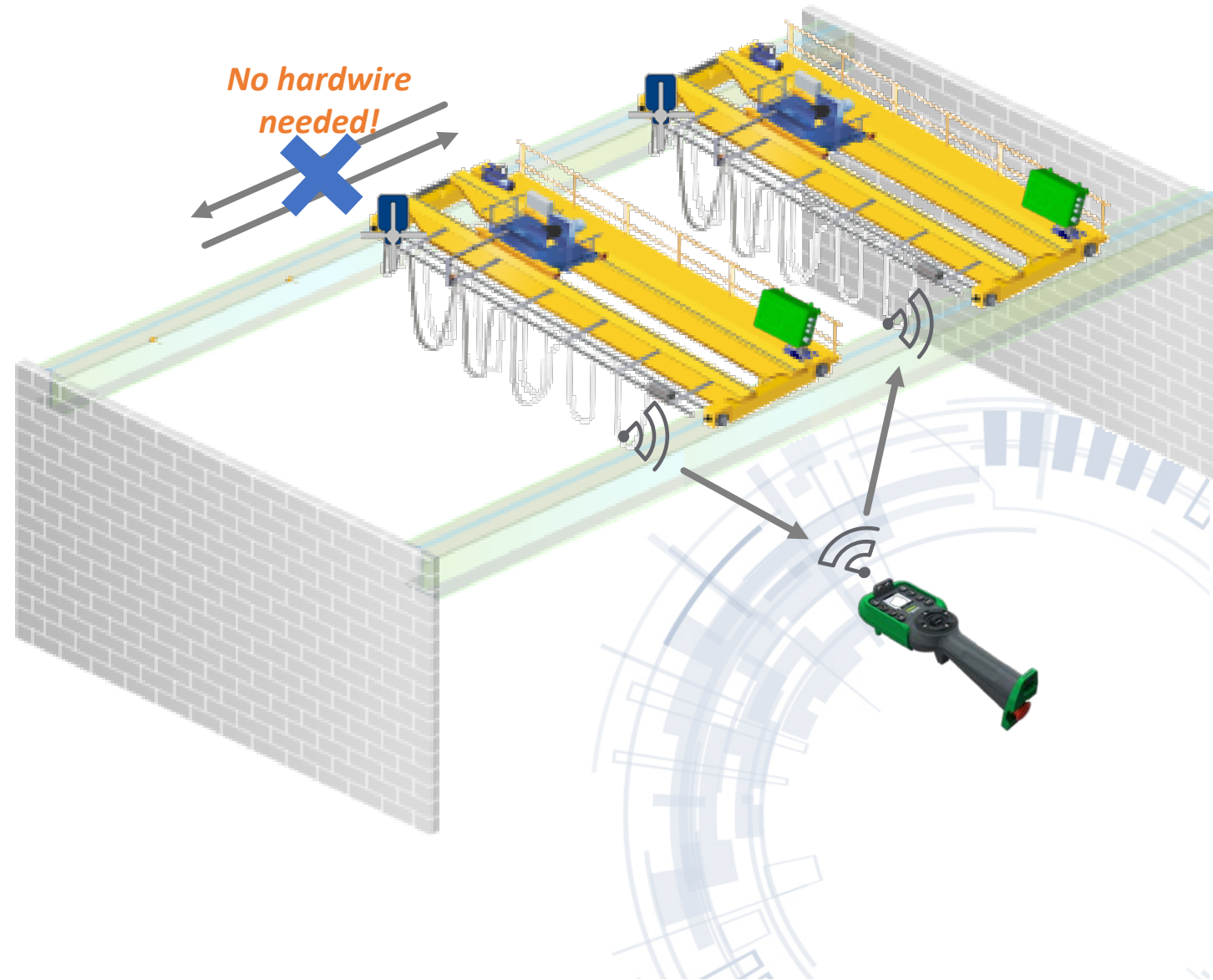

# Multi-base control function

New wireless limit switch function

- Limiter protection function includes the safety chain by using contactors feedback from mirror contact
  - Up to 12 inputs integrated on the base station for limit switch and overload management
- Detection of unintended motion and **time delay correction** of the tandem crane's synchronization is easy configurable by software

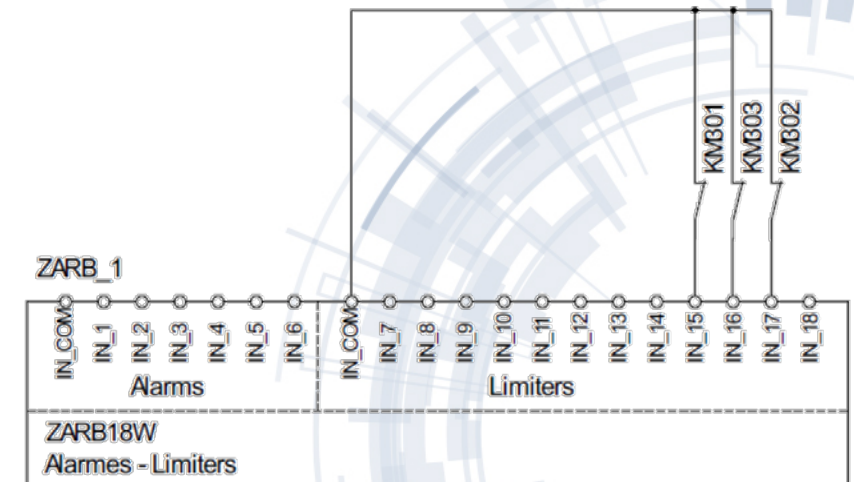
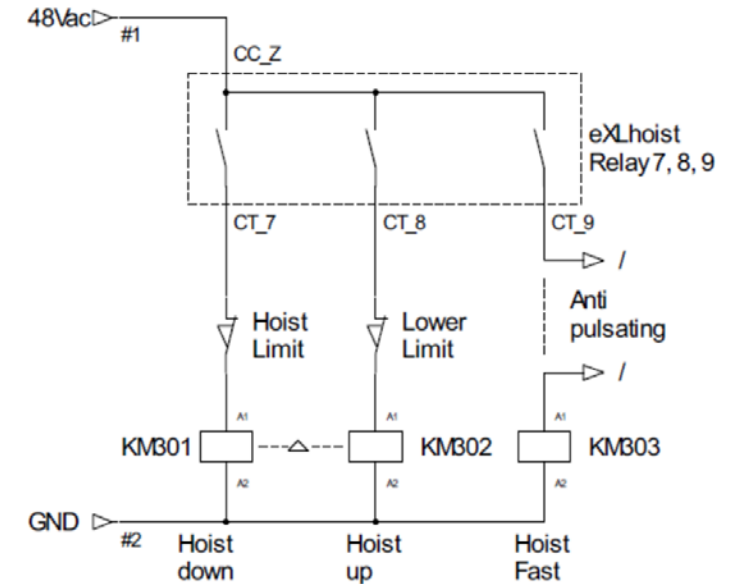



# Overload Function

Aligned with the new revision of standard EN ISO 13849-1

- Overload function **integrated** on the system without need of external safety module
- Two channels are used to comply with the Category 3 requirement
- Limit switch inputs embedded on the base station can reach the safety level required
- The base station send the analog information to the screen of the remote control via radio

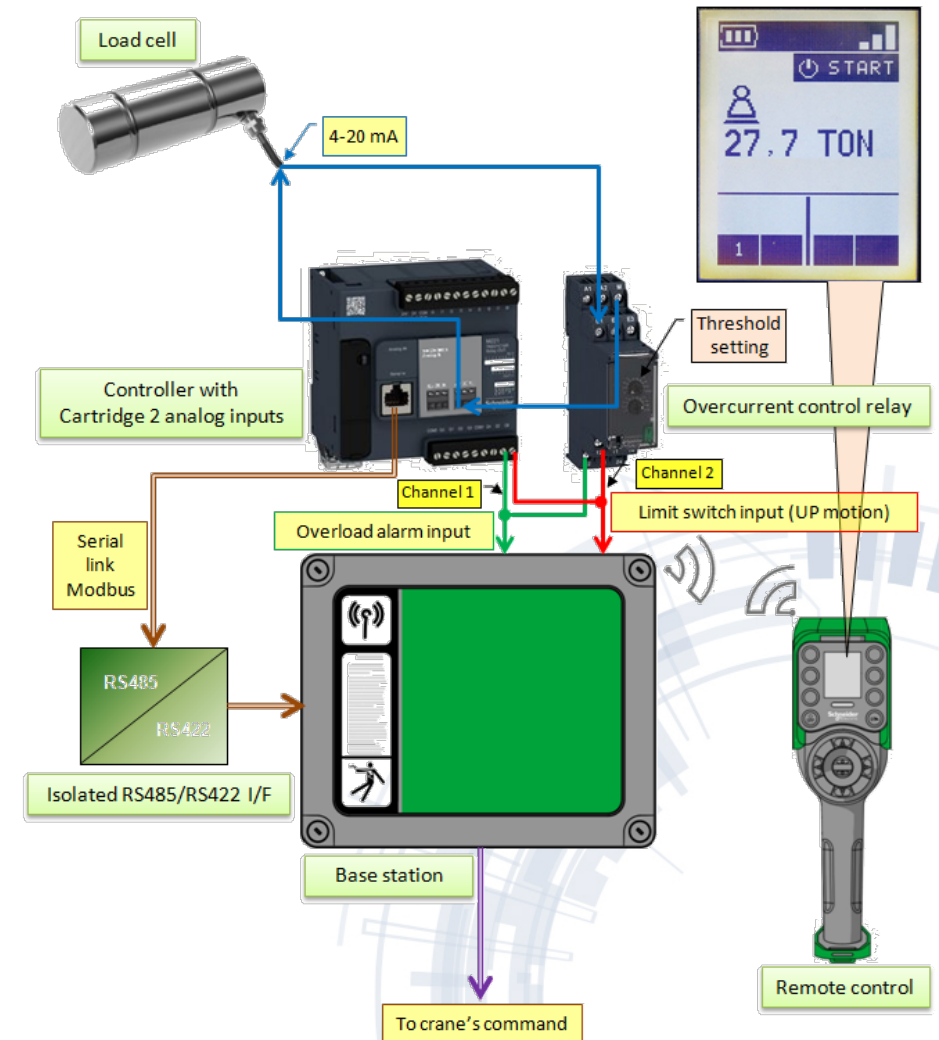

# Onscreen Display of Load Weight

Key data at your fingertips

- Display load weight information on the remote control:
  - Up two lines of data possible to visualize on the screen
  - Fast refresh rate of the load weight information on the display (around 600ms)
- **Maintenance data** from the 'black box' can be also displayed

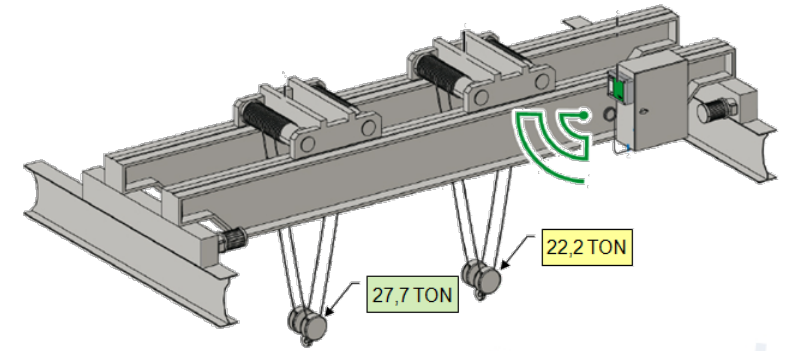



A photograph of two industrial workers, a man and a woman, standing in a large factory or warehouse. They are both wearing white hard hats and safety glasses. The man is in the foreground, wearing a dark blue work shirt with a red stripe on the collar. The woman is slightly behind him, also wearing a dark blue work shirt. They are both looking off to the side, towards the right. The background shows the complex steel structure of the building's roof and large windows, with some industrial equipment visible in the distance.

Control Equipment  
Ensure Safety  
Use a **Reliable Device**



# Crane Remote Accessories

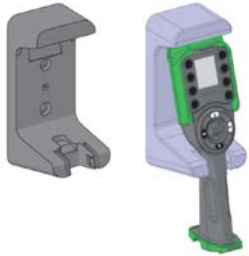

**ZARC04**

**Remote Holder**  
Wall mount



**ZARC03**

**External Antenna**  
to increase radio  
range in severe  
environments



**ZARC02**

**Shoulder Belt**  
for handsfree  
carry



**ZARC01**

**Remote Charger**  
with worldwide  
connector plug  
adapters

# Utilize the latest **Smart Technology**

Safety remains the primary reason for adopting wireless remote control systems. However, OEMs and end users should also consider factors such as reduced installation time and costs, improved operator mobility, and increased insight as to machine or process performance (preventive maintenance). Combined, these factors offer a significant competitive advantage over a wired solution.



# THANKS FOR WATCHING



## Contact Us



513-202-1408



[www.cincinnati-crane.com](http://www.cincinnati-crane.com)



[info@cincinnati-crane.com](mailto:info@cincinnati-crane.com)